

DIFFUSIVE LATH

CHARACTERISTIC

Diffusive lath - DLD is a two-piece plastic perforated lath, which is intended for an escape of diffuse water vapours from the masonry to the open space. Diffusive lath eliminates defects on the plasters, which rise from a reason of an excessive concentration of water vapour at the contact of the vertical plaster with the floor.

TECHNICAL PARAMETERS

Marking:	DLD-i 70/14	diffusive lath two-piece – interior
	DLD-e 70/14	diffusive lath two-piece – exterior
Dimension:	70 x 14 x 2000 mm	
Size of holes:	4 x 50 mm	
Number of holes:	40/running meter	
Material:	PVC	
Colour:	White – the surface can be modified by acrylate colours	
UV resistance:	The material contains the UV stabilizer; it is resistant against the UV radiation	

MATERIAL

The material used for the production (Rigid PVC) is non-toxic, non-hazardous and complies with EN 60332-1-2.

INSTALLATION

The lath is mounted at the level of the wear layers of the floor constructions onto a well cleaned masonry.

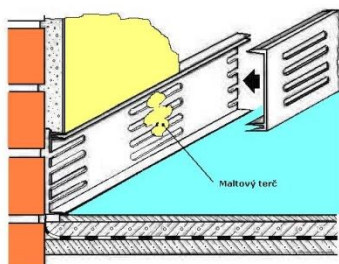

1) It could be anchored to the masonry by the help of the mortar targets (equivalent of laying of the white-ware tilling) in the spacing between 40 - 60 cm apart at the floor level, above the socle or at the level of an additionally performed damp proofing. The lath must be leveled into the screeds, the exterior lath into the amended screeds. After solidification the space behind the lath (if it's greater than 1,5cm) is filled with debris of bricks, to avoid filling of joints with mortar when plastering.

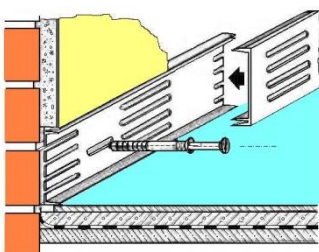

2) A dry installation can be carried out by the help of the nailing dowels and spacers, by which the area of the uneven masonry with the lath is adjusted. The best is to make the spacers from a plastic that constantly resists to a damp environment.

Before the installation is appropriate to provide the lath with a paint tape or foil as a prevention against damage.

The product meets the basic requirements according to statutory rules no. 163/2002 Code of Law for the intended way of use of the product.